

MATCH LINE

SEE SHEET 2

MATCH LINE

DIVISION II PART 'C' DETENTION BASIN

MATCH LINE

SEE SHEET 2

MATCH LINE

NOTE:
FOR DIVISION II PART 'C' THE MASS GRADING
PLAN IS THE SAME AS THE FINISH GRADING PLAN

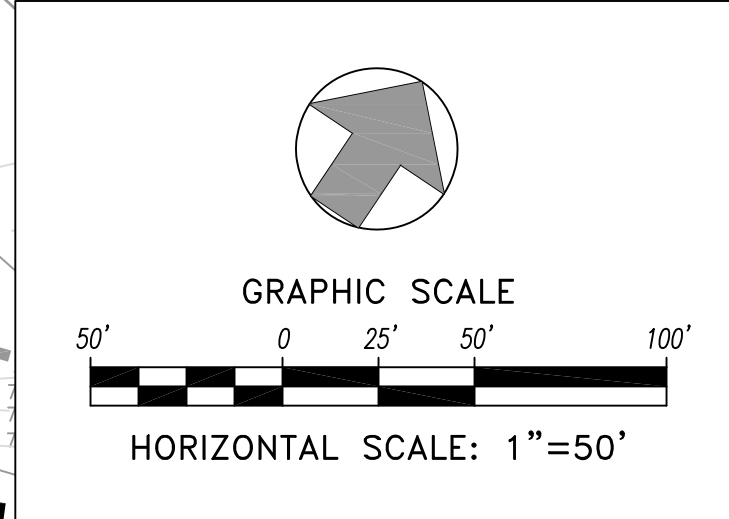

NOTE:
BUFFER ZONE MAY BE USED AS TOP
SOIL STORAGE AREA. EXCESS TOP
SOIL CAN BE STORED IN THIS AREA.
COORDINATE LOCATIONS AND SIZE
OF STORAGE PILES WITH
ELIZABETHTOWN INDUSTRIAL
FOUNDATIONS. PROTECT PILES BY
ENCIRCLING WITH SILT FENCE. TOP
SOIL NOT RE-USED FOR THIS
PROJECT MAY BE DISPOSED AT THIS
LOCATION IF SPREAD SMOOTHLY IN
"BERM" TYPE MOUNDS AND SEEDED.
DO NOT BLOCK ANY NATURAL
DRAINAGE CHANNELS

NOTE: IN ADDITION TO THE (ROUGH) GRADING TO THE CONTOURS SHOWN
ON THIS PAGE, THE MASS SITE GRADING FOR DIVISION II - PART 'A'
INCLUDES PLACING EROSION CONTROL MEASURES, EROSION MATS
AND TEMPORARY SEEDING

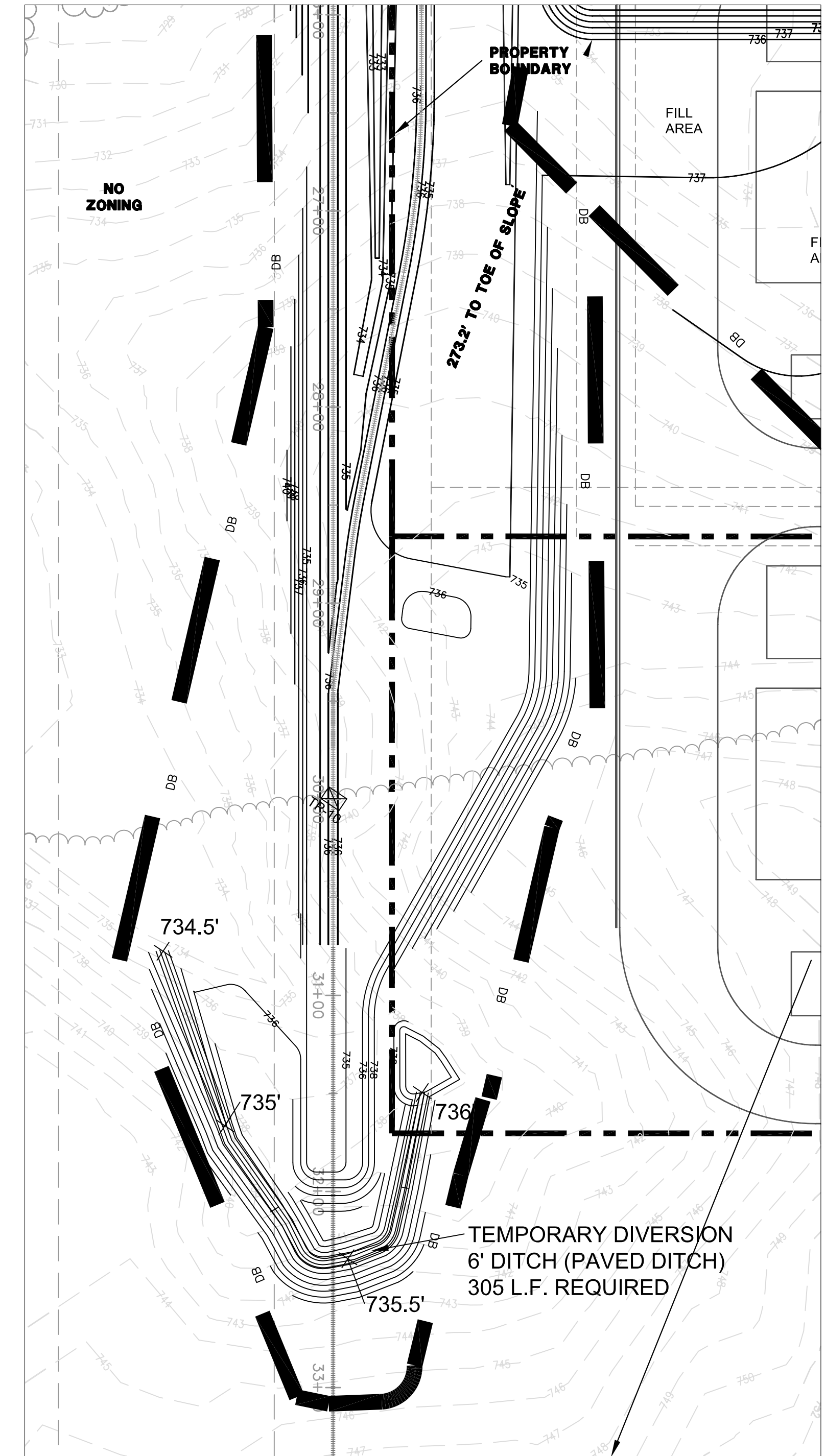

INSET - A
NOTE:
FOR DIVISION II PART 'B' THE MASS GRADING
PLAN IS THE SAME AS THE FINISH GRADING PLAN

DIVISION II PART 'B' RAIL SPUR

DIVISION II PART 'A' MASS SITE GRADING

BUILDING 'A'
FINISH FLOOR ELEVATION = 749.00

FUTURE BUILDING 'B'
FINISH FLOOR ELEVATION = 749.00

FUTURE EXPANSION
LOT 8C
31.606 ACRES

GENERAL NOTE:
ALL PAVED DITCHES, DITCH IMPROVEMENTS AND
STORM DRAINAGE CONSTRUCTION SHOWN IN
THE FINISH GRADING WORK AND FINISH SITE
WORK-BID ITEM, "DIVISION II - PART 'C'"
SEE SHEET C-101.4

FLEX FILMS (U.S.A.) INC.
1221 NORTH BLACK BRANCH ROAD
ELIZABETHTOWN, KENTUCKY 42702

PROJECT L-12 BOPET U.S.A.

DATE	REVISION

PROJECT NO. 2064-25	DESIGNED BY G.A.R.
DRAWN BY J.R.M.	CHECKED BY G.A.R.
DATE JUNE 2011	SCALE AS SHOWN

nsc
OF KENTUCKY, INC.

Engineers
Architects
Planners

624 Wallington Way
Lexington, KY 40503
www.nscinc.com

Phone: (859) 223-5684
Fax: (859) 223-2607

DRAWING NO.
**UFL-L12
C-101.2**

AUG 05 11:20:04 - 25 FLEX FILM - ELIZABETHTOWN INDUSTRIAL PARK, C-101.2 AND 101.3 MASS SITE GRADING PLANNING